

FOR LEASE ±15,459 SF

FREESTANDING INDUSTRIAL BUILDING WITH LARGE YARD

2980 E. La Jolla St., Anaheim, CA



Property Features

- 15,459 Sq. Ft. Freestanding Industrial Building
- 5,047 Sq. Ft. of Well-Appointed Office Areas (can be reduced to suit)
- Large Fenced Yard Area
- Drive-Around Building
- 3 Ground Level Loading Doors (4 Possible)
- 400 Amps of 120/208 Volt Power
- 16' Warehouse Clearance
- Fire Sprinklers
- Excellent Access to 57 and 91 Freeways
- Street Frontage with Corner Location

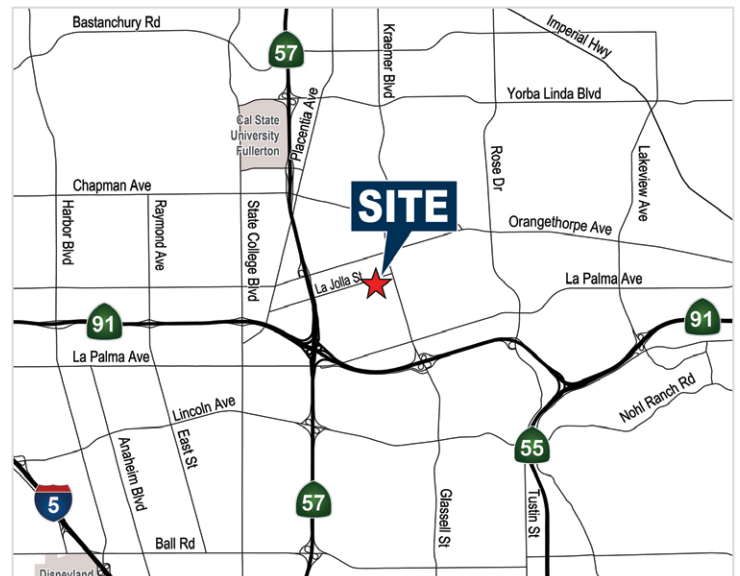

MIKE HEFNER, SIOR
Executive Vice President
714.935.2331
Lic. #00857352
mhefner@voitco.com

MIKE VERNICK, CCIM, SIOR
Senior Vice President
714.935.2354
Lic. # 01420885
mvernicky@voitco.com

Voit
REAL ESTATE SERVICES

**HEFNER
VERNICK
TEAM**

FOR LEASE ±15,459 SF

FREESTANDING INDUSTRIAL BUILDING

2980 E. La Jolla St., Anaheim, CA

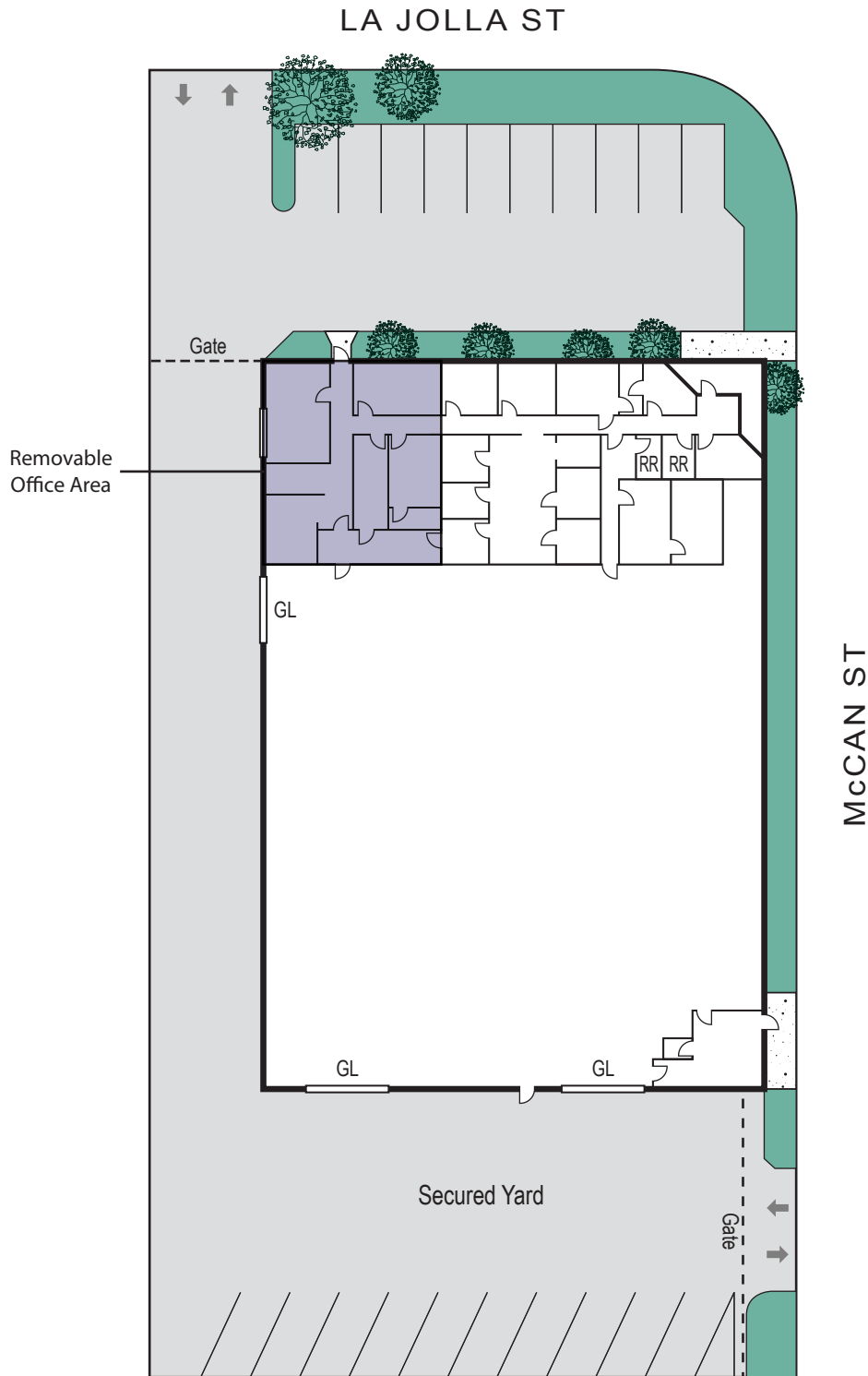

MIKE HEFNER, SIOR
Executive Vice President
714.935.2331
Lic. #00857352
mhefner@voitco.com

MIKE VERNICK, CCIM, SIOR
Senior Vice President
714.935.2354
Lic. # 01420885
mvernick@voitco.com

Voit
REAL ESTATE SERVICES

HV HEFNER
VERNICK
TEAM

2400 E. Katella Ave., Suite 750, Anaheim, CA 92806 • 714.978.7880 • 714.978.9431 Fax

Licensed as Real Estate Broker(s) and Salesperson by the CA Bur of Real Estate. The information contained herein has been obtained from sources we deem reliable. While we have no reason to doubt its accuracy, we do not guarantee it. ©2017 Voit Real Estate Services, Inc. All Rights Reserved. License #0133376.

www.VoitCo.com
www.HefnerVernickTeam.com