

FOR LEASE

±14,925 Square Feet Industrial

Ready for Immediate Occupancy



2700 Saturn Street, Unit B, Brea

Property Features:

- ±1,300 Sq. Ft. of Office Area
- One (1) Dock High Door (Expandable to 3 Positions)
- One (1) Ground Level Door
- 20' Warehouse Clearance
- 400 Amps of 277/480 Volt Power (Verify)
- Excellent Access to 57 and 91 Freeways
- High Image Building
- Located Near Numerous Retail/Restaurant Amenities
- Covered Loading Area
- Exterior Refurbishment Completed
- Fire Sprinklers
- New Roof

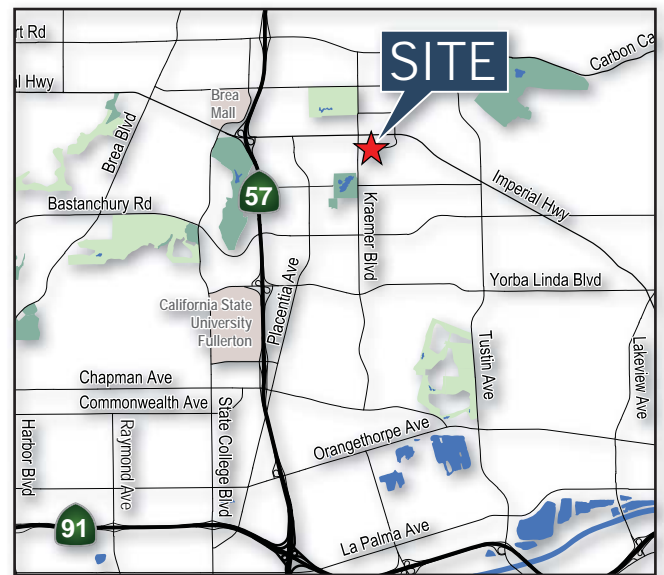

Mike Hefner, SIOR
Executive Vice President
714.935.2331
mhefner@voitco.com
Lic #00857352

Mike Vernick, CCIM, SIOR
Vice President
714.935.2354
mvernick@voitco.com
Lic. #01420885

Voit
REAL ESTATE SERVICES

2400 E. Katella Avenue, Suite 750, Anaheim, CA 92806 • 714.978.7800 • 714.978.9431 Fax • Lic #01333376 | www.voidco.com | www.hefnerteam.com

Real People. Real Solutions.®

FOR LEASE

±14,925 Square Feet

2700 Saturn Street, Unit B, Brea

SITE PLAN

SATURN ST.

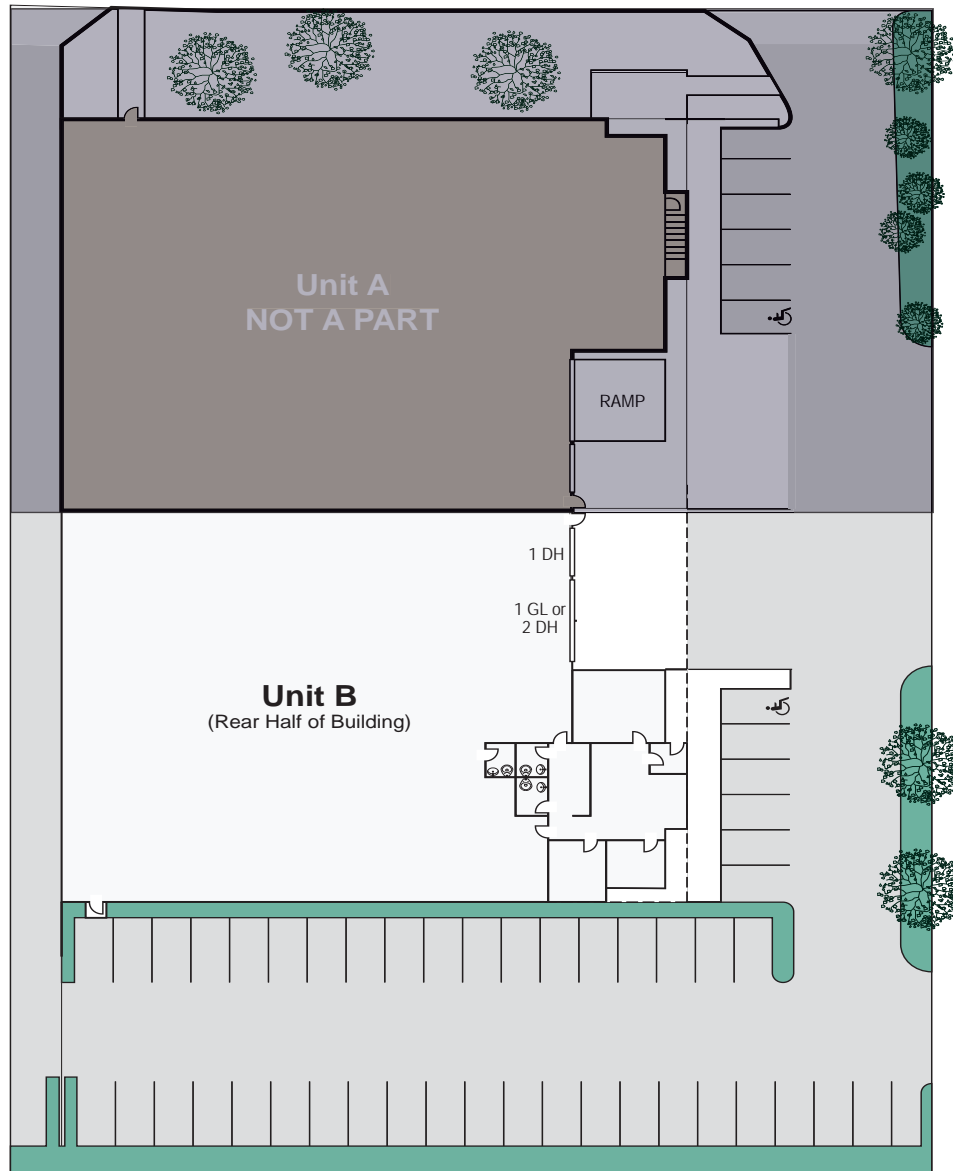

Mike Hefner, SIOR
Executive Vice President
714.935.2331
mhefner@voitco.com
Lic #00857352

Mike Vernick, CCIM, SIOR
Vice President
714.935.2354
mvernick@voitco.com
Lic. #01420885

Voit
REAL ESTATE SERVICES

2400 E. Katella Ave., Suite 750, Anaheim, CA 92806 • 714.978.7880 • 714.978.9431 Fax • Lic #01333376 | www.voitco.com