

# FOR LEASE ±26,094 SF

FREE STANDING INDUSTRIAL BUILDING ON 2.03 ACRES OF LAND

1617 E. Ball Road, Anaheim, CA



## Property Feature

- Major Street Exposure and Signage
- Approximately 5,094 Sq. Ft. Office Area
- Ideal for Vocational Schools
- Retail Showroom Potential
- 800 AMPS of Power
- 6:1000 Parking Ratio (Potentially 163 Stalls On Site)
- Large Fenced Yard Area
- 17' Clearance (verify)
- Fire Sprinklered
- Three (3) Dock High Truck Doors
- Ground Level Door Possible
- 254' of Ball Road Frontage
- Immediate Access to Pomona (57) and Santa Ana (5) Freeways

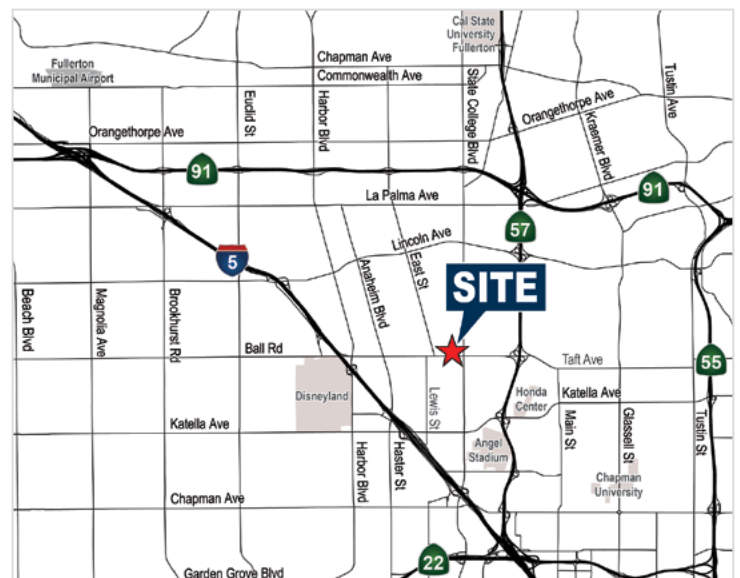

**MIKE HEFNER, SIOR**  
Executive Vice President  
714.935.2331  
Lic. #00857352  
mhefner@voitco.com

**Voit**  
REAL ESTATE SERVICES

**HV** HEFNER  
VERNICK  
TEAM

**DONALD E. KAZANJIAN**  
President & Principal  
909.373.2929  
Lic. #00976995  
dkazanjian@lee-assoc.com

**LEE & ASSOCIATES®**  
COMMERCIAL REAL ESTATE SERVICES

# FOR LEASE ±26,094 SF

## FREE STANDING INDUSTRIAL BUILDING ON 2.03 ACRES OF LAND

1617 E. Ball Road, Anaheim, CA

### SITE PLAN

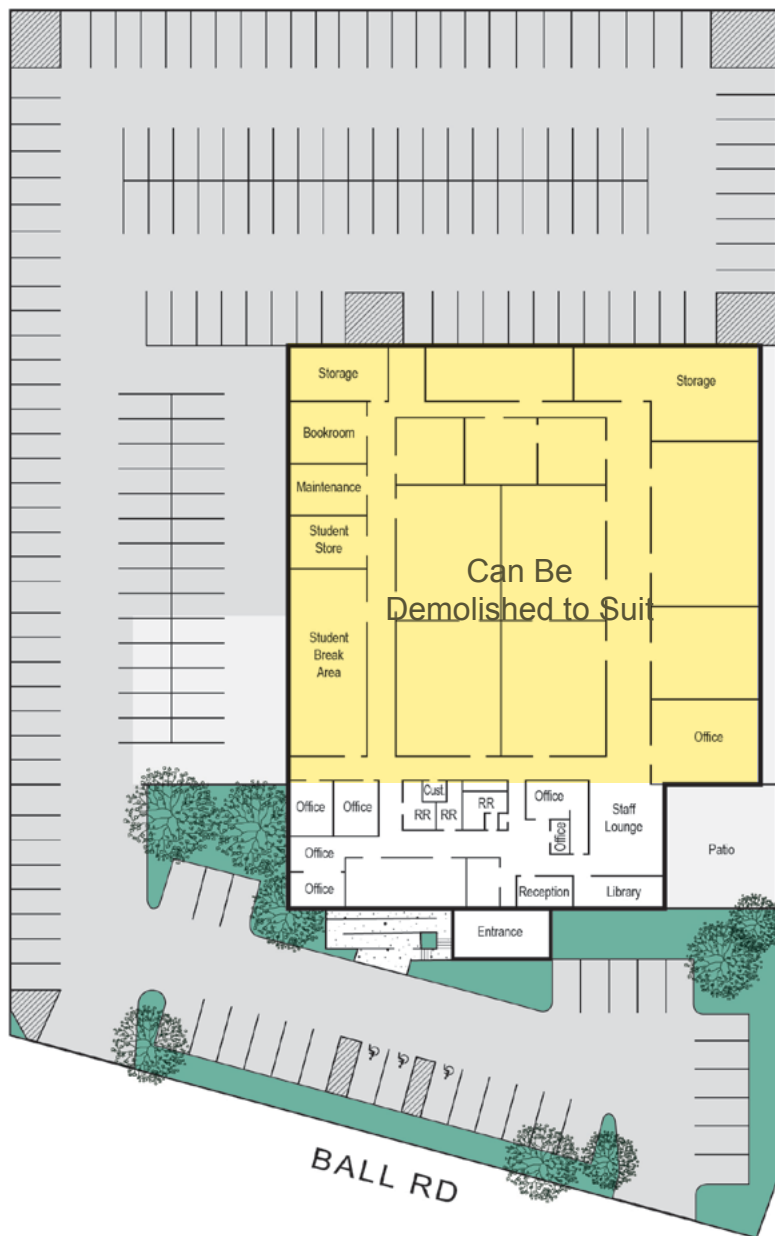

**MIKE HEFNER, SIOR**  
Executive Vice President  
714.935.2331  
Lic. #00857352  
mhefner@voitco.com



**DONALD E. KAZANJIAN**  
President & Principal  
909.373.2929  
Lic. #00976995  
dkazanjian@lee-assoc.com

