

FOR LEASE

± 6,174 Square Feet

Voit
REAL ESTATE SERVICES



4720 E. Hunter Avenue, Anaheim

Property Features

- Approximately 1,650 Sq. Ft. Office Area
- Fenced Yard Area
- Fire Sprinklered
- Two 12' x 14' Ground Level Doors
- 400 Amps of 277/480 Volt Power
- 15' of Interior Clearance
- Metal Halide Lighting in Warehouse
- Excellent Access to the 55, 57, and 91 Freeways



Morgan Hill
Senior Associate
714.935.2322
MHill@voitco.com
Lic. #01877356

Mike Hefner, SIOR
Executive Vice President
714.935.2331
MHefner@voitco.com
Lic #00857352

Voit
REAL ESTATE SERVICES

HV HEFNER
VERNICK
TEAM

2400 E. Katella Avenue, Suite 750, Anaheim, CA 92806 • 714.978.7880 • 714.978.9431 Fax • Lic #01333376 | www.voitco.com

Real People. Real Solutions.®

FOR LEASE

± 6,174 Square Feet

4720 E. Hunter Avenue, Anaheim

Site Plan

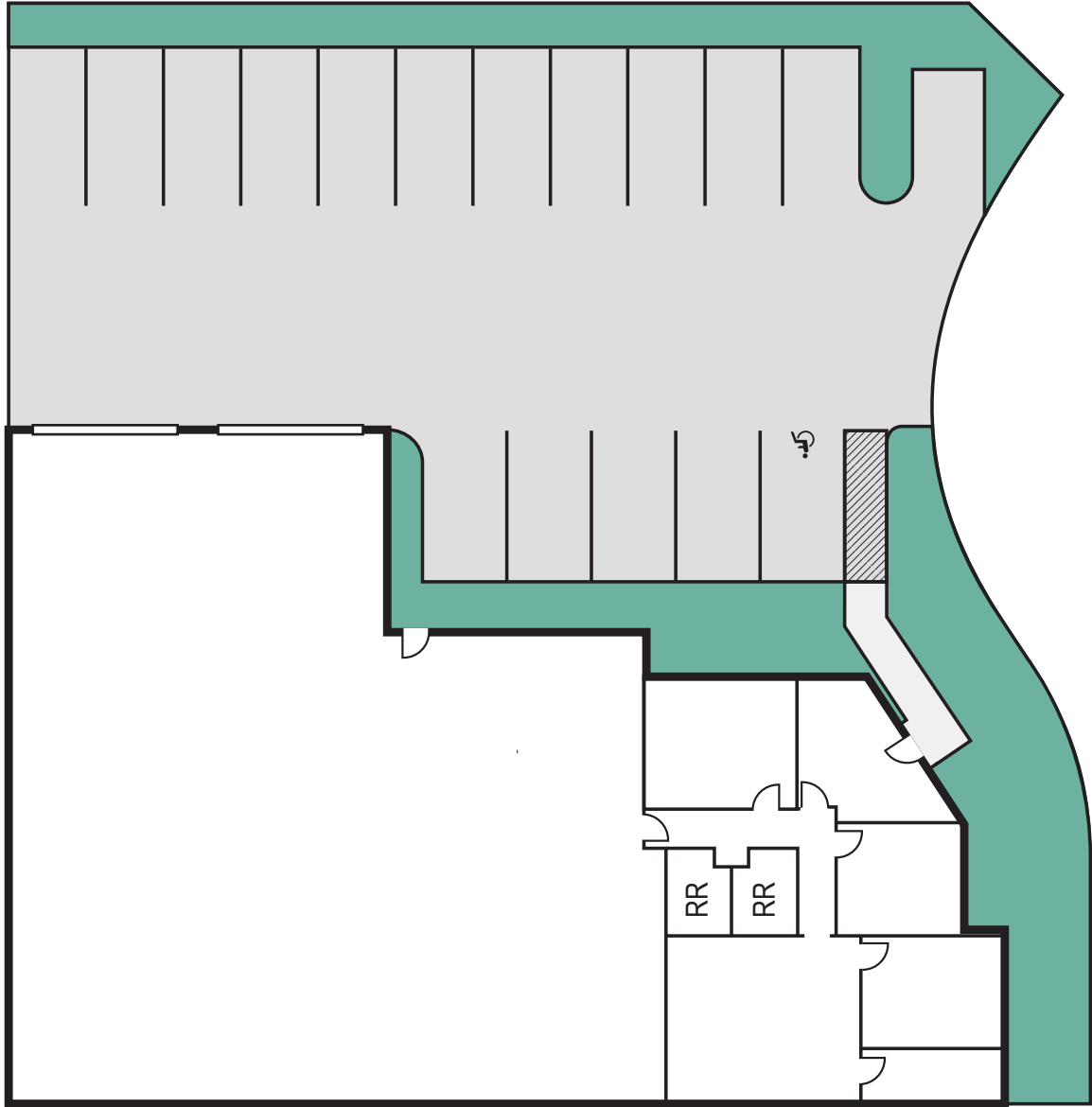

Morgan Hill
Senior Associate
714.935.2322
MHill@voitco.com
Lic. #01877356

Mike Hefner, SIOR
Executive Vice President
714.935.2331
MHefner@voitco.com
Lic #00857352

Voit
REAL ESTATE SERVICES

HV HEFNER
VERNICK
TEAM

2400 E. Katella Ave., Suite 750, Anaheim, CA 92806 • 714.978.7880 • 714.978.9431 Fax • Lic #01333376 | www.voitco.com