

FOR LEASE

±5,249 Square Feet

Voit

REAL ESTATE SERVICES



1429 S. VERNON ST., ANAHEIM

Property Features

- ±1,277 Sq. Ft. of Office / Showroom Area
- One (1) 12' x 12' Ground Level Door; Two (2) Man Doors
- Eleven (11) Parking Stalls
- 16' - 20' Warehouse Clearance
- Ample Skylights in Warehouse
- No CAM Fees
- 400 AMPS of Power
- Convenient Access to the 57, 5, 91 and 22 Freeways
- Attractive Anaheim Utility Rates
- In Tile Mile Area; Near Disneyland and Platinum Triangle

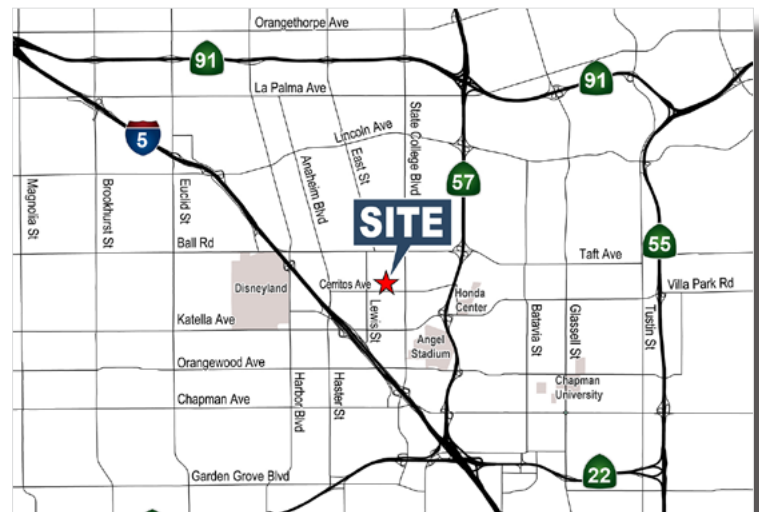

MIKE VERNICK, CCIM, SIOR

Senior Vice President
714.935.2354
mvernick@voitco.com
Lic. #01420885

MORGAN HILL

Vice President
714.935.2322
mhill@voitco.com
Lic. #01877356

Voit
REAL ESTATE SERVICES

HV HEFNER
VERNICK
TEAM

FOR LEASE

±5,249 Square Feet

1429 S. Vernon St., Anaheim

Site Plan

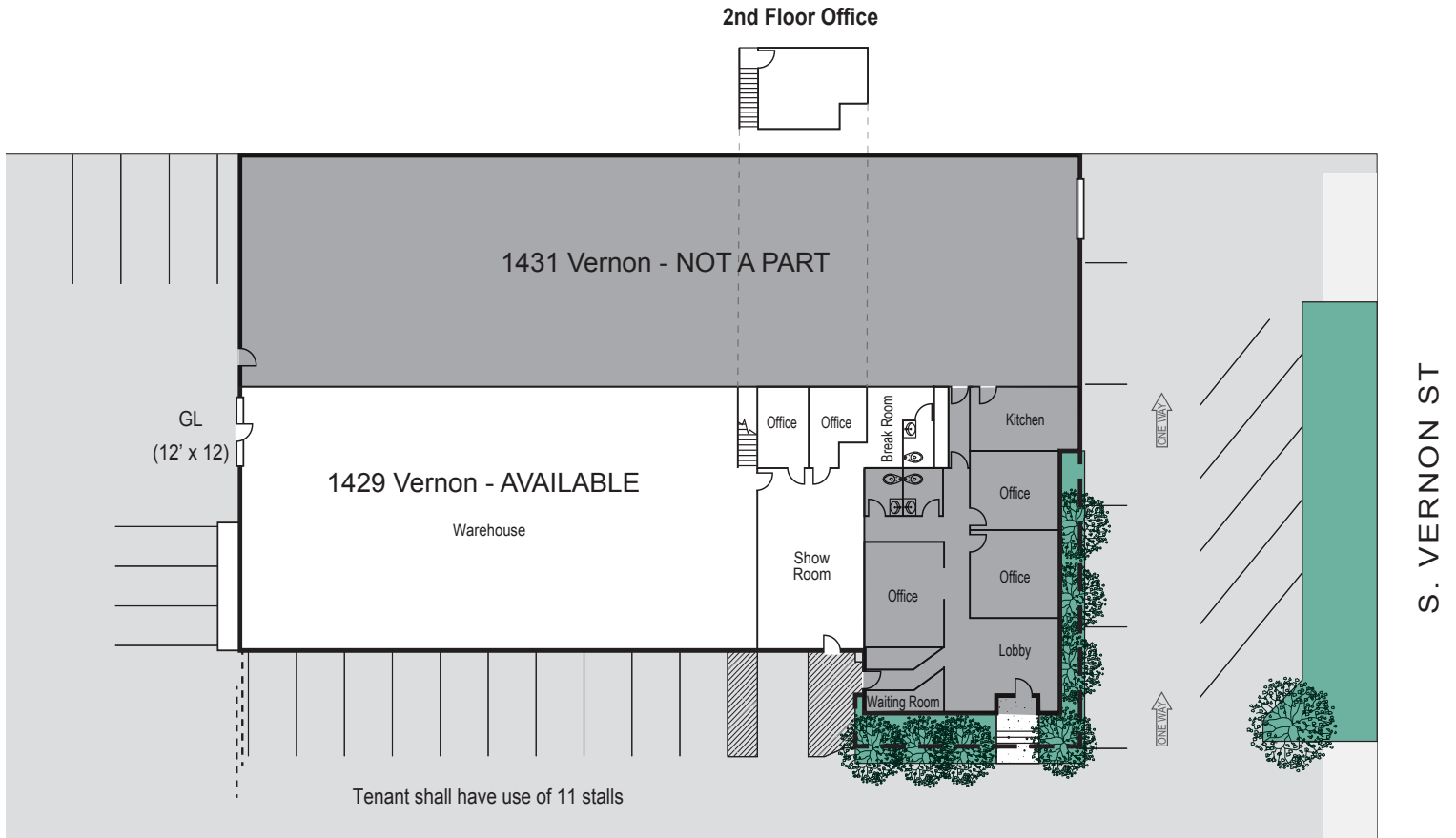

MIKE VERNICK, CCIM, SIOR
Senior Vice President
714.935.2354
mvernick@voitco.com
Lic. #01420885

MORGAN HILL
Vice President
714.935.2322
mhill@voitco.com
Lic. #01877356

Voit
REAL ESTATE SERVICES

HV HEFNER
VERNICK
TEAM

2400 E. Katella Avenue, Suite 750, Anaheim, CA 92806 • 714.978.7880 • 714.978.9431 Fax • Lic #01333376

www.VoitCo.com

Licensed as Real Estate Broker by the CA Bur of Real Estate. The information contained herein has been obtained from sources we deem reliable. While we have no reason to doubt its accuracy, we do not guarantee it. ©2017 Voit Real Estate Services, Inc. All Rights Reserved. License #01333376.