

FOR LEASE ±6,486 SF

FREESTANDING INDUSTRIAL BUILDING

290 N. Smith Ave., Corona, CA 92882



Property Features

- ± 6,486 Sq. Ft. Freestanding Building
- ± 1,100 Sq. Ft. of Office Space
- Two (2) Ground Level Loading Doors
- 200 Amps of Power; 120/240 Volt
- ± 15' Warehouse Clearance
- Shop Restrooms
- Large Fenced Yard
- Convenient Access to the 91, 15 and 71 Freeways



MIKE HEFNER, SIOR
Executive Vice President
714.935.2331
Lic. #00857352
mhefner@voitco.com

BRENDEN HEFNER
Associate
714.978.2326
Lic. #02114046
bhefner@voitco.com

Voit
REAL ESTATE SERVICES

**HEFNER
VERNICK
TEAM**

FOR LEASE ±6,486 SF

FREESTANDING INDUSTRIAL BUILDING

290 N. Smith Ave., Corona, CA 92882

SITE PLAN

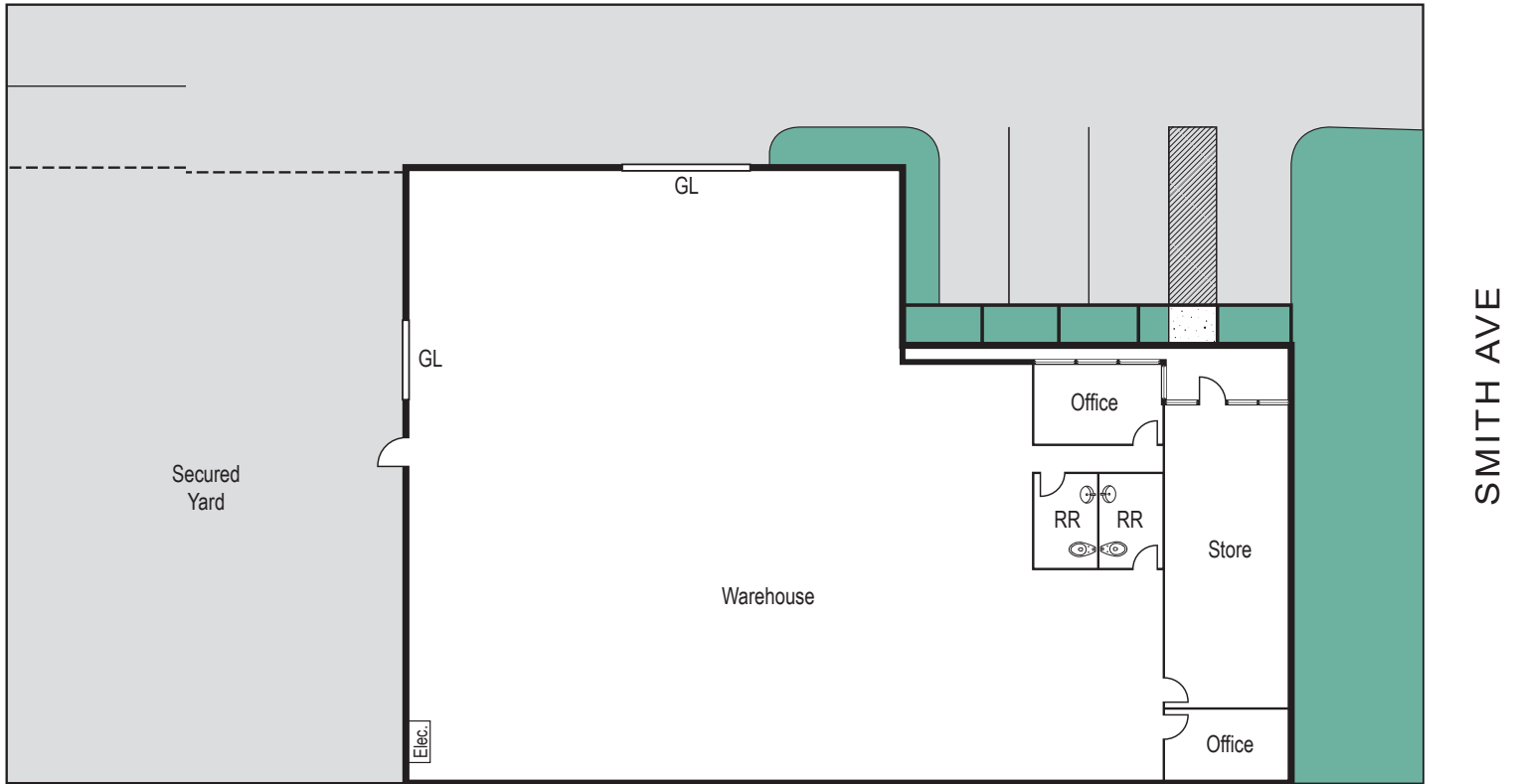

* Site plan not to scale.

MIKE HEFNER, SIOR
Executive Vice President
714.935.2331
Lic. #00857352
mhefner@voitco.com

BRENDEN HEFNER
Associate
714.978.2326
Lic. #02114046
bhefner@voitco.com

Voit
REAL ESTATE SERVICES

HV HEFNER
VERNICK
TEAM

2400 E. Katella Ave., Suite 750, Anaheim, CA 92806 • 714.978.7880 • 714.978.9431 Fax

www.HefnerVernickTeam.com

Licensed as Real Estate Broker by the CA Bur of Real Estate. The information contained herein has been obtained from sources we deem reliable. While we have no reason to doubt its accuracy, we do not guarantee it. ©2022 Voit Real Estate Services, Inc. All Rights Reserved. License #01991785.