

FOR LEASE ±10,650 SF INDUSTRIAL BUILDING

2181 S. Dupont Drive, Anaheim, CA



Property Features

- ± 10,650 SF Industrial Building
- ± 1,500 SF of Office Area
- Two (2) Ground Level Doors
- 12' - 14' Warehouse Clearance (Verify)
- Large Fenced Yard Area
- 600 Amps 277/480 Volts
- Prime Stadium Location
- 1.9:1,000 Parking Ratio (Verify)
- Fire Sprinklered
- Immediate Access to Santa Ana (5), Pomona (57), and Garden Grove (22) Freeways

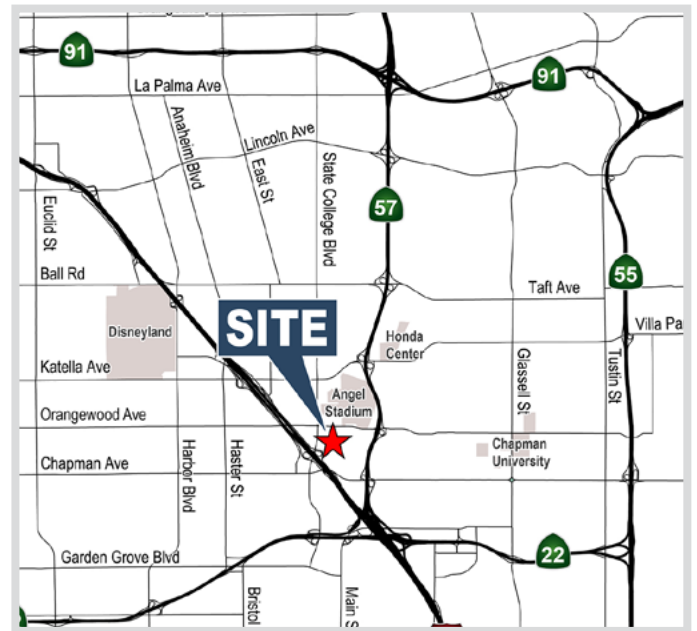

MIKE HEFNER, SIOR
Executive Vice President
714.935.2331
Lic. #00857352
mhefner@voitco.com

Voit
REAL ESTATE SERVICES

**HEFNER
VERNICK
TEAM**

FOR LEASE ±10,650 SF

INDUSTRIAL BUILDING

2181 S. Dupont Drive, Anaheim, CA

SITE PLAN

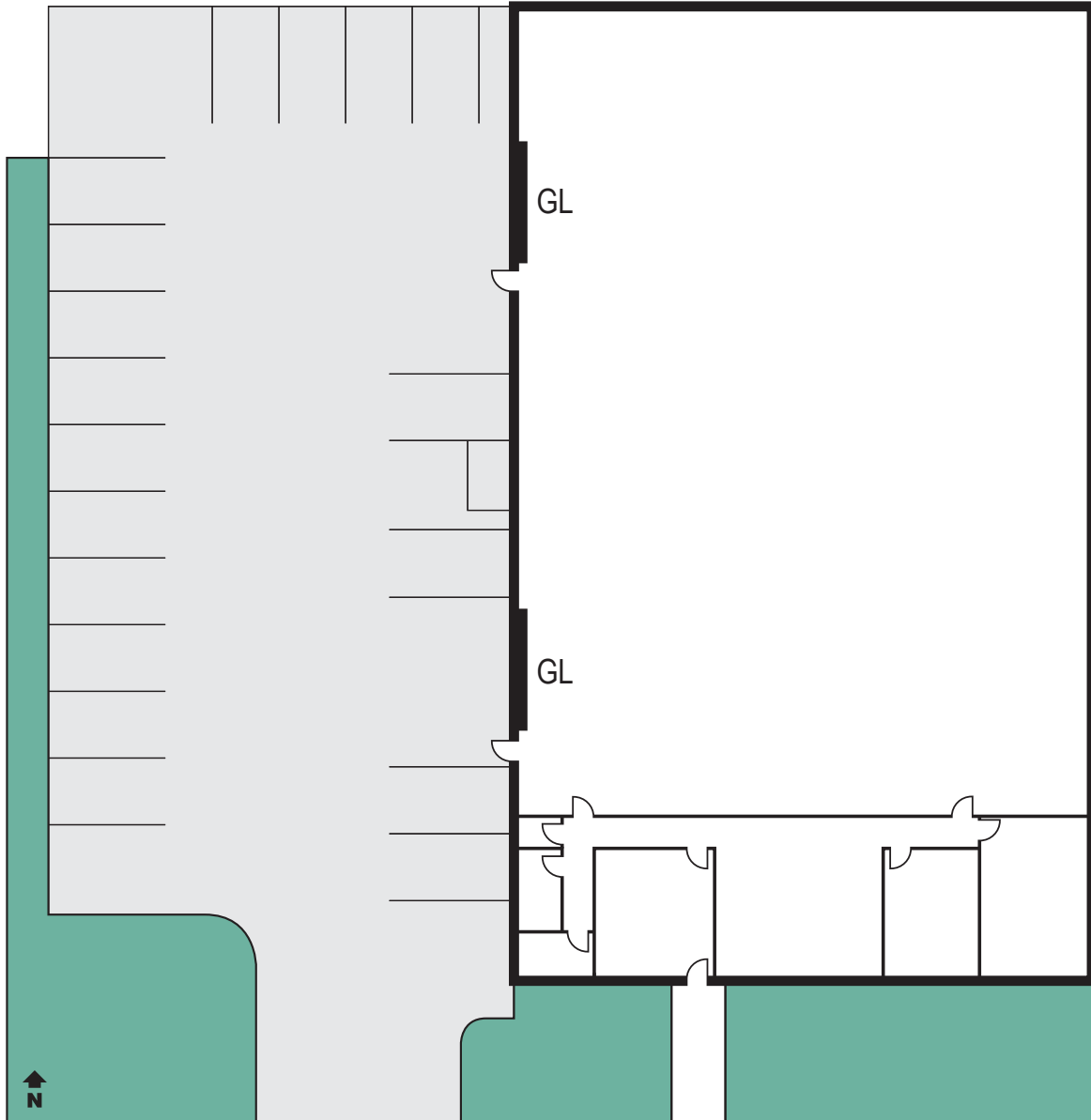

DUPONT DR.

* Site plan not to scale.

MIKE HEFNER, SIOR
Executive Vice President
714.935.2331
Lic. #00857352
mhefner@voitco.com

Voit
REAL ESTATE SERVICES

**HEFNER
VERNICK
TEAM**

2400 E. Katella Ave., Suite 750, Anaheim, CA 92806 • 714.978.7880 • 714.978.9431 Fax

www.HefnerVernickTeam.com

Licensed as Real Estate Broker by the CA Bur of Real Estate. The information contained herein has been obtained from sources we deem reliable. While we have no reason to doubt its accuracy, we do not guarantee it. ©2022 Voit Real Estate Services, Inc. All Rights Reserved. License #01991785.