



**345 CESSNA CIR., SUITE A/B**  
Corona, CA

**±113,050 SQ. FT.**  
**FOR LEASE**

## PROPERTY FEATURES

- High-Image Freestanding Industrial Building
- ± 12,000 SF of Office Area
- 2:1,000 Parking Ratio (225 Stalls)
- Built in 2003
- ± 30' Warehouse Ceiling Height
- ESFR (K-25) Fire Sprinkler System (Verify)
- 7 Ground Level Doors
- 9 Dock High Loading Doors
- 4,000 Amps; 277/480 Volt, Well Distributed Power
- Excellent Access to the Riverside (91) and 15 Freeways



**MIKE HEFNER, SIOR**  
Executive Vice President  
714.935.2331  
Lic. #00857352  
mhefner@voitco.com

**PAUL CAPUTO, MBA**  
Senior Vice President  
714.935.2332  
Lic. #01196935  
pcaputo@voitco.com

**Voit**  
REAL ESTATE SERVICES

3280 E. Guasti Rd.  
Suite 100  
Ontario, CA 91761  
Lic #01991785  
[www.VoitCo.com](http://www.VoitCo.com)

# SITE PLAN

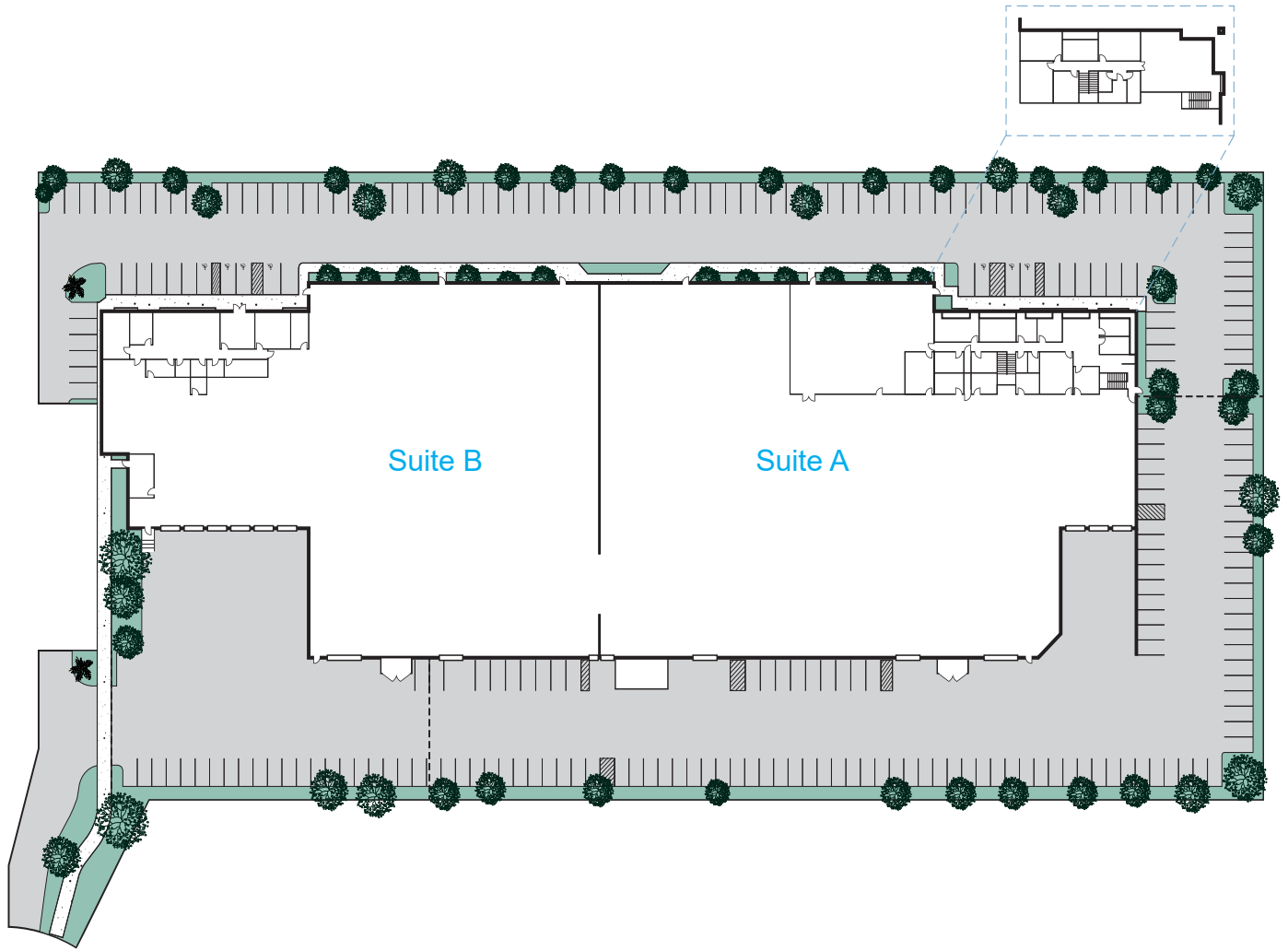

\*Site plan not to scale.

**345 CESSNA CIR., SUITE A/B**  
Corona, CA

**±113,050 SQ. FT.**  
**FOR LEASE**

**MIKE HEFNER, SIOR**  
Executive Vice President  
714.935.2331  
Lic. #00857352  
mhefner@voitco.com

**PAUL CAPUTO, MBA**  
Senior Vice President  
714.935.2332  
Lic. #01196935  
pcaputo@voitco.com

**Voit**  
REAL ESTATE SERVICES

3280 E. Guasti Rd.  
Suite 100  
Ontario, CA 91761  
Lic #01991785  
[www.VoitCo.com](http://www.VoitCo.com)