

FOR LEASE ±27,985 SF

FREESTANDING INDUSTRIAL BUILDING

2200 S. Dupont Avenue, Anaheim, CA

READY FOR OCCUPANCY



Property Features

- Approximately 5,185 Sq. Ft. of Upgraded Office Area
- Large Fenced Yard Area
- Three (3) Ground Level Doors
- Exterior Truckwell
- Fire Sprinklered
- 18' - 21' Warehouse Clearance
- 1,200 Amps of 277/480 Volt Power
- Prime Anaheim Stadium Location
- Immediate Access to Pomona (57), Garden Grove (22) and Santa Ana (5) Freeways



MIKE HEFNER, SIOR
Executive Vice President
714.935.2331
Lic. #00857352
mhefner@voitco.com

Voit
REAL ESTATE SERVICES

**HEFNER
VERNICK
TEAM**

FOR LEASE ±27,985 SF

FREESTANDING INDUSTRIAL BUILDING

2200 S. Dupont Avenue, Anaheim, CA

SITE PLAN

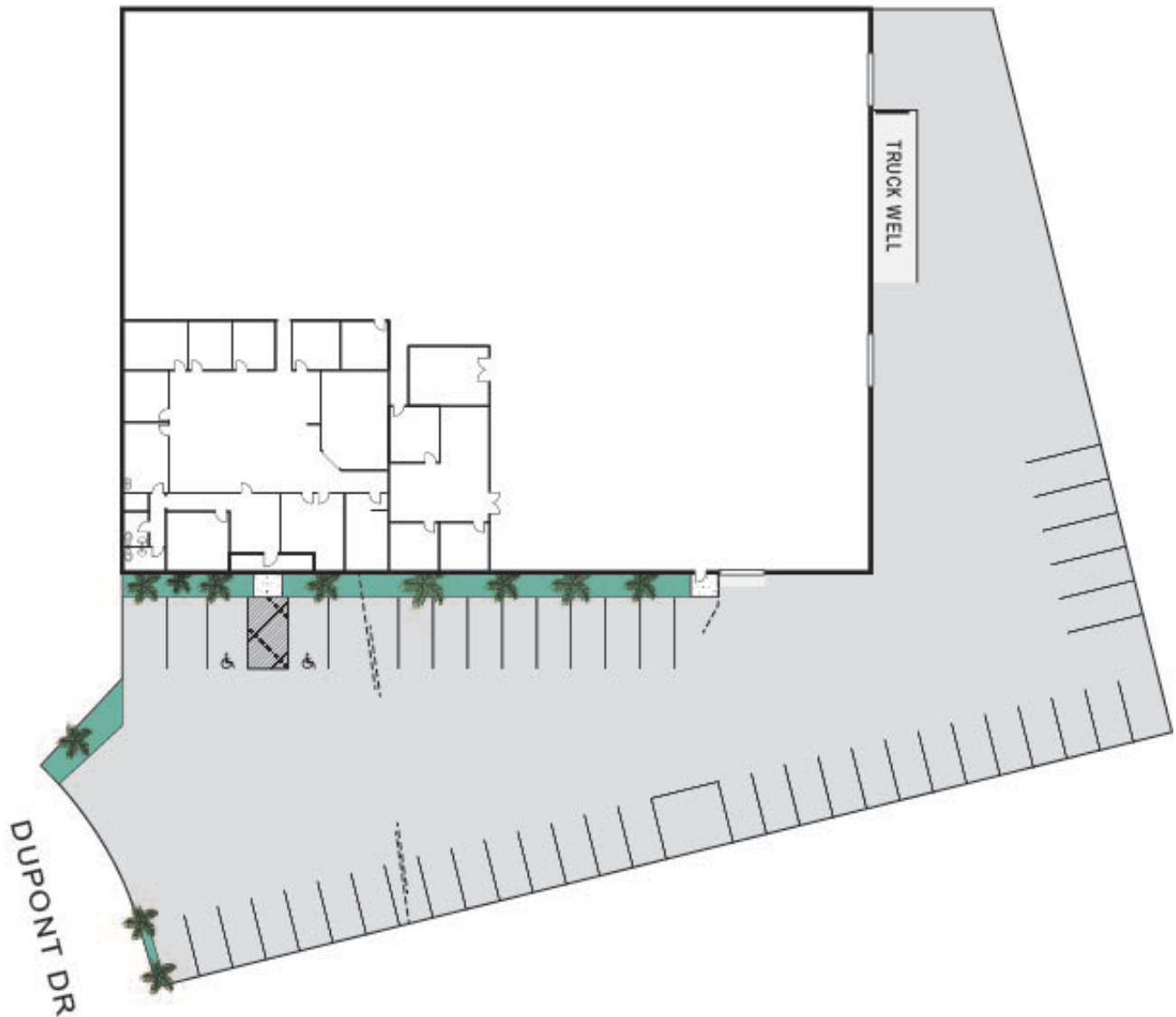

MIKE HEFNER, SIOR
Executive Vice President
714.935.2331
Lic. #00857352
mhefner@voitco.com

Voit
REAL ESTATE SERVICES

HV HEFNER
VERNICK
TEAM

2400 E. Katella Ave., Suite 750, Anaheim, CA 92806 • 714.978.7880 • 714.978.9431 Fax

www.HefnerVernickTeam.com

Licensed as Real Estate Broker(s) and Salesperson by the CA Bur of Real Estate. The information contained herein has been obtained from sources we deem reliable. While we have no reason to doubt its accuracy, we do not guarantee it. ©2020 Voit Real Estate Services, Inc. All Rights Reserved. License #01991785.