

FOR LEASE ±73,335 SF

SITUATED ON 4.2 ACRES OF LAND EXPANDABLE TO 5.1 ACRES

1177 Grove Street, Anaheim, CA

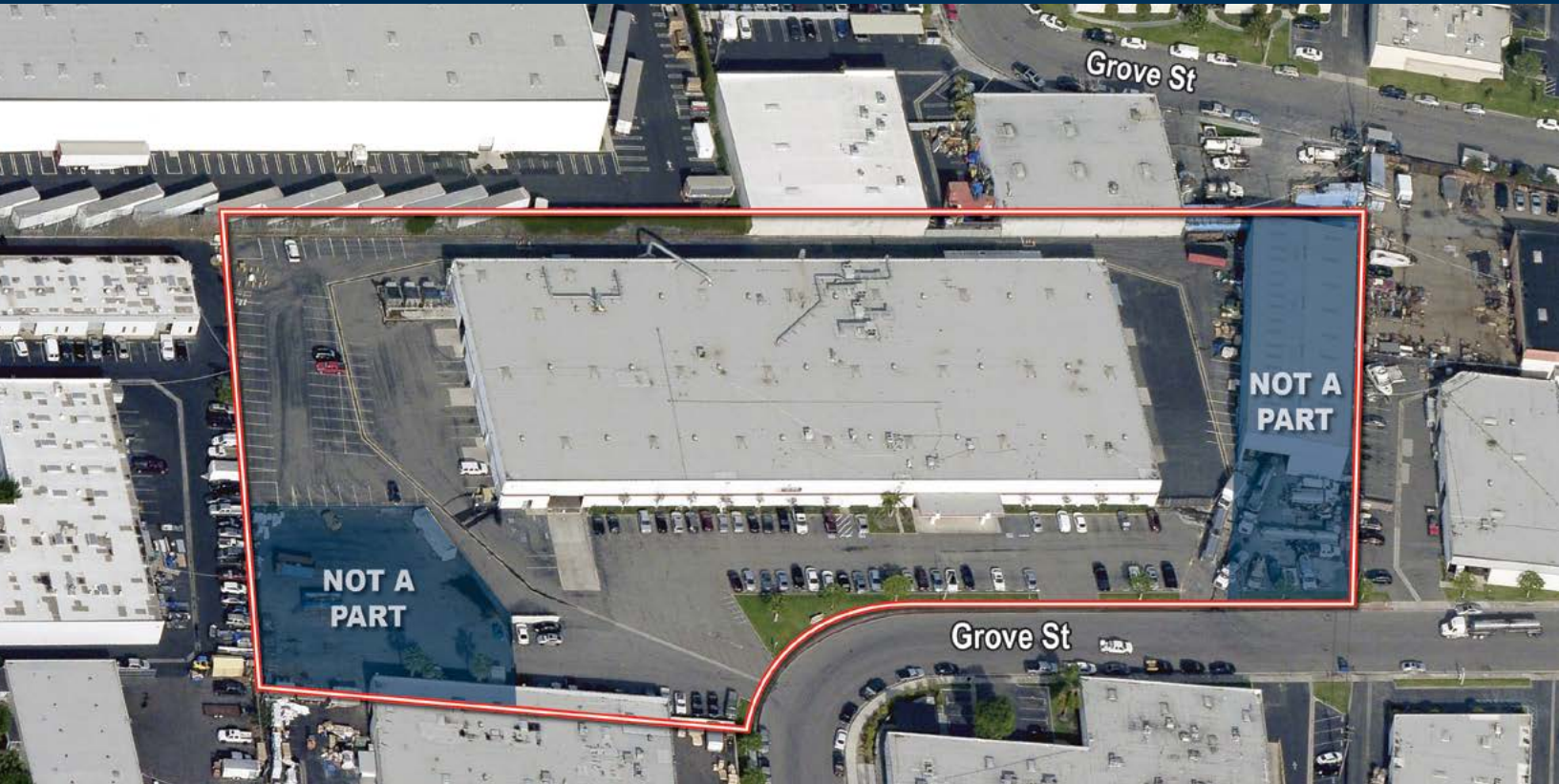

Property Features

- Freestanding Building
- Approximately 4,630 Sq. Ft. of Two Story Office Space
- 20' Minimum Clearance (Verify)
- Large Fenced Yard Area
- Ten (10) Ground Level Doors (12' x 12')
- Three (3) Truckwells (Expandable)
- Fire Sprinklered (.33/3000 GPM)
- LED Lighting Throughout
- 3,000 Amps of Well Distributed 277/480 Volt Power
- Immediate Access to the Riverside (91), Costa Mesa (55), and the Pomona (55) Freeways

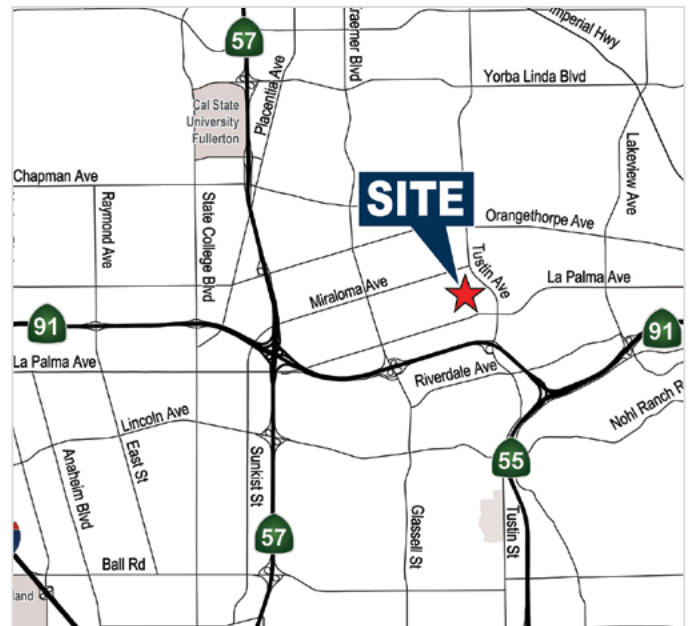

MIKE HEFNER, SIOR
Executive Vice President
714.935.2331
Lic. #00857352
mhefner@voitco.com

BRENDEN HEFNER
Associate
714.935.2326
Lic. #02114046
bhefner@voitco.com

Voit
REAL ESTATE SERVICES

**HEFNER
VERNICK
TEAM**

FOR LEASE ±73,335 SF

SITUATED ON 4.2 ACRES OF LAND EXPANDABLE TO 5.1 ACRES

1177 Grove Street, Anaheim, CA

SITE PLAN

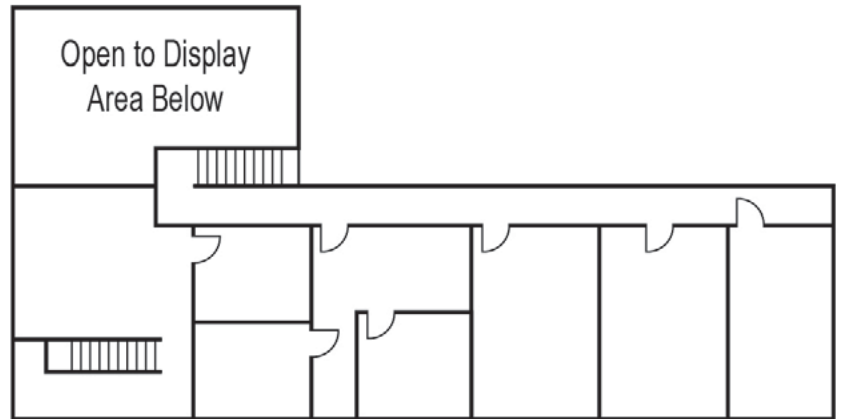
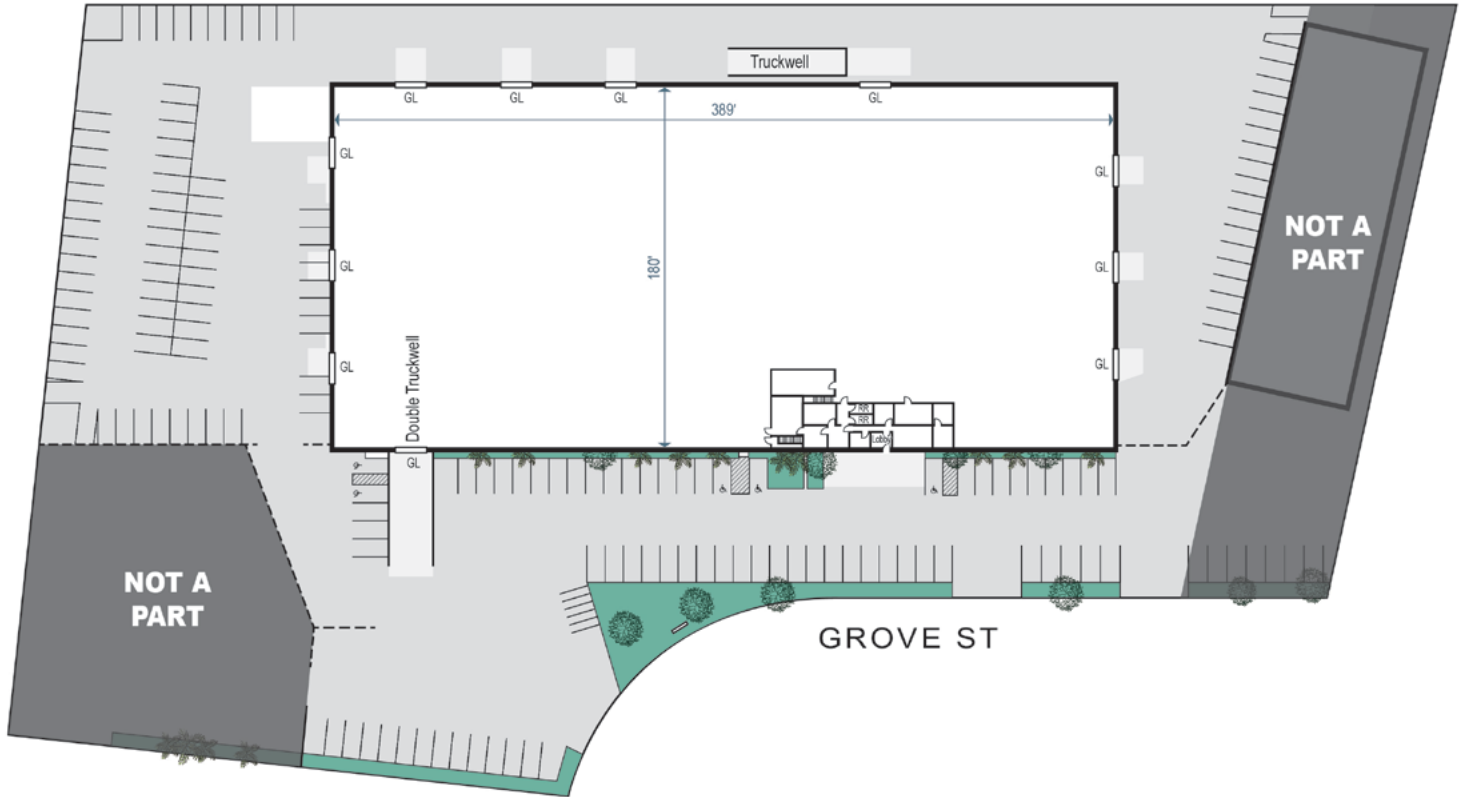

SECOND STORY OFFICE AREA

MIKE HEFNER, SIOR
Executive Vice President
714.935.2331
Lic. #00857352
mhefner@voitco.com

BRENDEN HEFNER
Associate
714.935.2326
Lic. #02114046
bhefner@voitco.com

Voit
REAL ESTATE SERVICES

**HEFNER
VERNICK
TEAM**

2400 E. Katella Ave., Suite 750, Anaheim, CA 92806 • 714.978.7880 • 714.978.9431 Fax

www.HefnerVernickTeam.com

Licensed as Real Estate Broker(s) and Salesperson by the CA Bur of Real Estate. The information contained herein has been obtained from sources we deem reliable. While we have no reason to doubt its accuracy, we do not guarantee it. ©2019 Voit Real Estate Services, Inc. All Rights Reserved. License #01991785.