

**380**

**CLIFFWOOD PARK ST  
BREA, CA**



**FOR SALE**

**32,000 Sq. Ft. Freestanding Industrial Building**

***Voit***  
REAL ESTATE SERVICES

**HV** HEFNER  
VERNICK  
TEAM

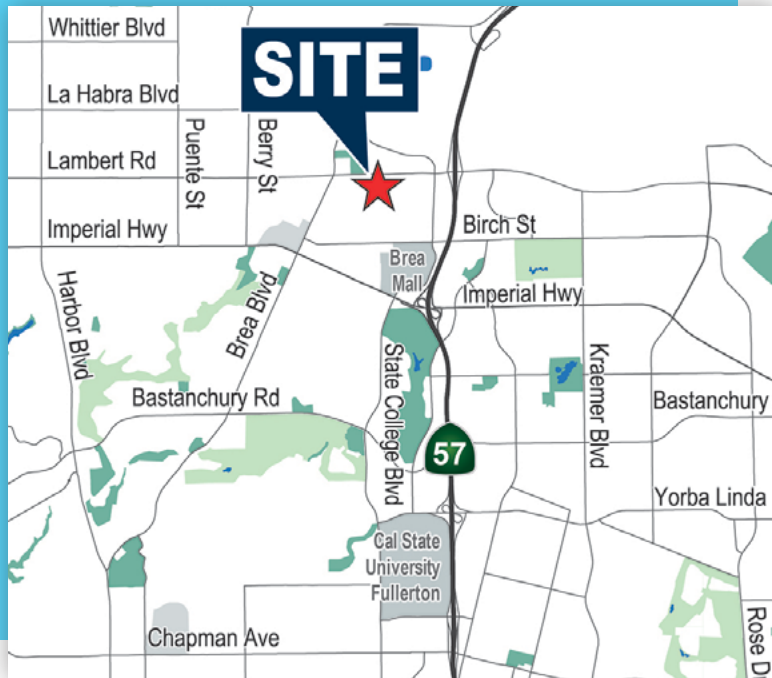

## PROPERTY FEATURES

- » ±32,000 Sq. Ft. Freestanding Industrial Building
- » ±1.39 Acre Land Parcel
- » ±26,880 Sq. Ft. Warehouse
- » ±9,557 Sq. Ft. of Two-Story Office Space
- » ±24' Warehouse Clearance
- » One (1) Ground Level Loading Door (Expandable)
- » Fully Fire Sprinklered
- » Fenced Yard Area, Corner Location
- » ±2.00/1,000 Sq. Ft. Parking Ratio

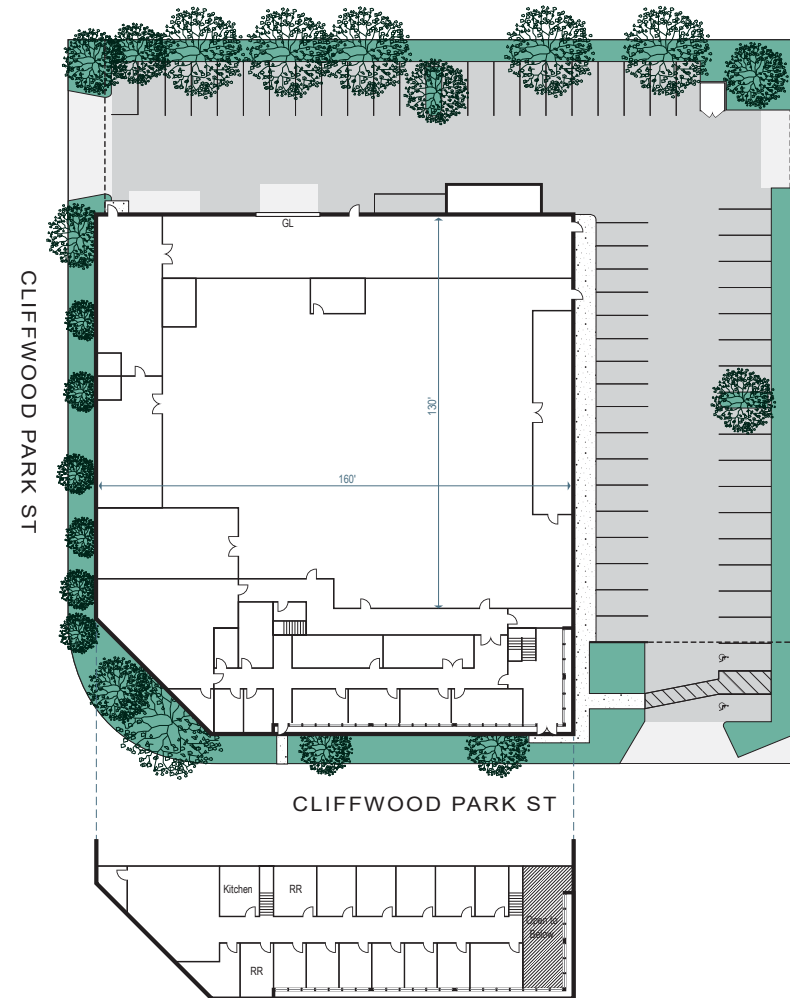

Second Floor

- » Large Power Service - ±1,600 Amps, 480 Volt Service Panel (verify)
- » Excellent Location Near Brea Mall & Brea Marketplace
- » Immediate Access to 57 Freeway 1/2 Mile East

Note: Site Plan Not to Scale.

## PROPERTY FEATURES





**380**  
**CLIFFWOOD PARK ST**  
**BREA, CA**

Cliffwood Park St

Cliffwood Park St

**MIKE HEFNER, SIOR**

Executive Vice President  
714.935.2331  
mhefner@voitco.com  
Lic. #00857352

**BRENDEN HEFNER**

Senior Associate  
714.935.2326  
bhefner@voitco.com  
Lic #02114046

**NICK DIGIOVANNI**

Associate  
714.935.2350  
ndigiovanni@voitco.com  
Lic #02213131

**Voit**

REAL ESTATE SERVICES



**HEFNER  
VERNICK  
TEAM**

2400 E. Katella Avenue, Suite 750  
Anaheim, CA 92806  
714.978.7880 | 714.978.9431 Fax  
www.voitco.com