

INDUSTRIAL SPACE FOR LEASE



# 141,616 SF

**4260 N. Harbor Boulevard  
Fullerton, CA 92835**

Prologis Beckman Business  
Center

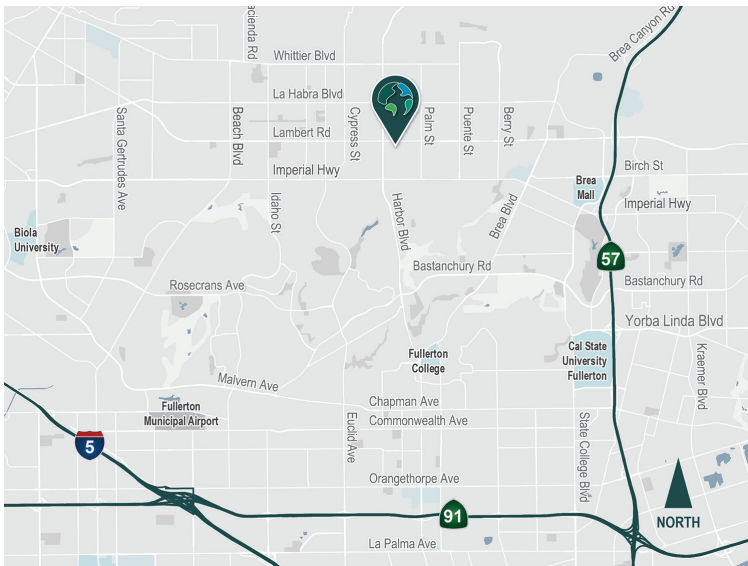

- High Image Industrial Business Park
- Excellent Access to the 57, 60 and 91 Freeways
- Harbor Boulevard Street Frontage
- Corner Location at Signalized Intersection

## Property Features

Available Space	141,616 SF
Office SF	6,365 SF
Clear Height	32'
Column Spacing	52' x 60'
Dock Doors	13
Drive-in Doors	2
Yard Area	Secured Yard
Car Parking Spaces	121
Electrical Service	2,000 amps
Sprinkler	ESFR
Lighting	LED Motion Sensor



Unlock the full potential of your  
warehouse with one strategic,  
single-source partner.

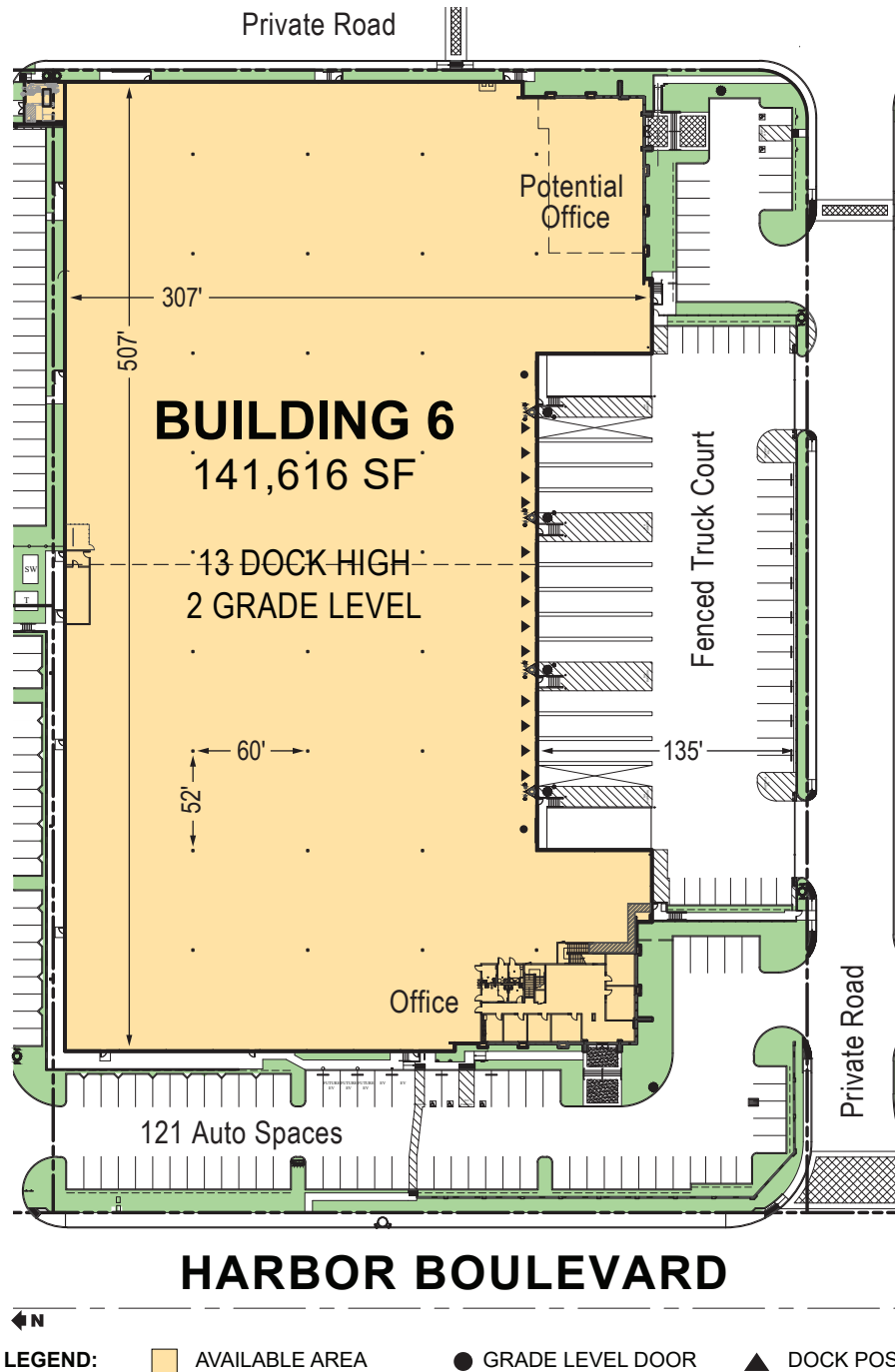

**Voit Real Estate Services**  
**Mitch Zehner**  
mzehner@voitco.com  
CalDRE License# 00882464  
ph +1 714 935 2307  
www.voitco.com

**Voit Real Estate Services**  
**Michael Hefner**  
mhefner@voitco.com  
CalDRE License# 00857352  
ph +1 714 978 7880  
www.voitco.com

**Prologis**  
**Parker Hutchison**  
phutchisonl@prologis.com  
CalDRE License# 01875578  
ph +1 562 345 9209  
prologis.com