

FOR LEASE ±5,065 SF

INDUSTRIAL BUILDING

745 Debra Lane, Anaheim, CA



Property Features

- Approximately ± 700 Square Feet of Office Space Available
- Large Fenced Yard Area
- 16' Warehouse Clearance
- Two (2) Ground Level Doors
- 400 Amps of Power
- 3:1 Parking Ratio
- Prime Stadium Location
- Convenient Access to the 5 and 57 Freeways

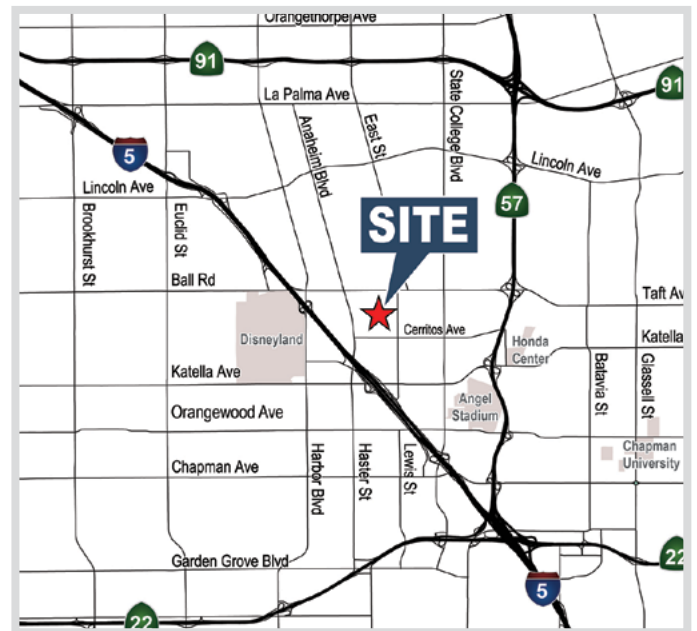

MIKE HEFNER, SIOR
Executive Vice President
714.935.2331
Lic. #00857352
mhefner@voitco.com

BRENDEN HEFNER
Senior Associate
714.935.2326
Lic. #02114046
bhefner@voitco.com

Voit
REAL ESTATE SERVICES

HV HEFNER
VERNICK
TEAM

FOR LEASE ±5,065 SF

INDUSTRIAL BUILDING

745 Debra Lane, Anaheim, CA

SITE PLAN

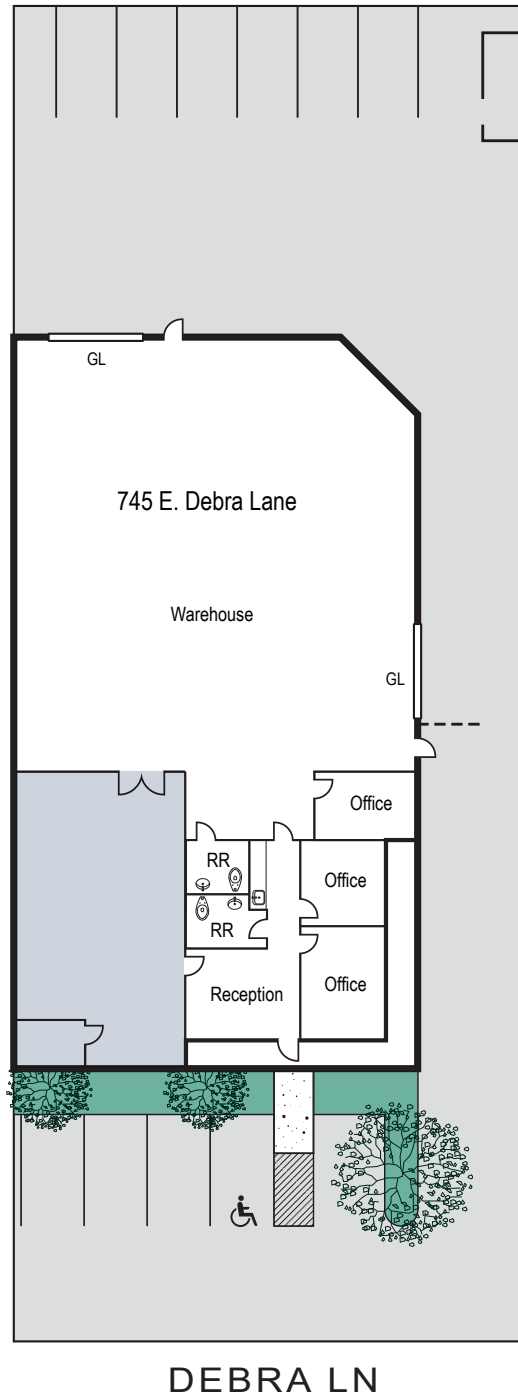

* Site plan not to scale.

MIKE HEFNER, SIOR
Executive Vice President
714.935.2331
Lic. #00857352
mhefner@voitco.com

BRENDEN HEFNER
Senior Associate
714.935.2326
Lic. #02114046
bhefner@voitco.com

Voit
REAL ESTATE SERVICES

HV HEFNER
VERNICK
TEAM

2400 E. Katella Ave., Suite 750, Anaheim, CA 92806 • 714.978.7880 • 714.978.9431 Fax

www.HefnerVernickTeam.com

Licensed as Real Estate Broker(s) and Salesperson by the CA Bur of Real Estate. The information contained herein has been obtained from sources we deem reliable. While we have no reason to doubt its accuracy, we do not guarantee it. ©2023 Voit Real Estate Services, Inc. All Rights Reserved. License #01991785.