

FOR LEASE | ±10,839 SF INDUSTRIAL BUILDING

1000 E. HOWELL AVE. | ANAHEIM | CA

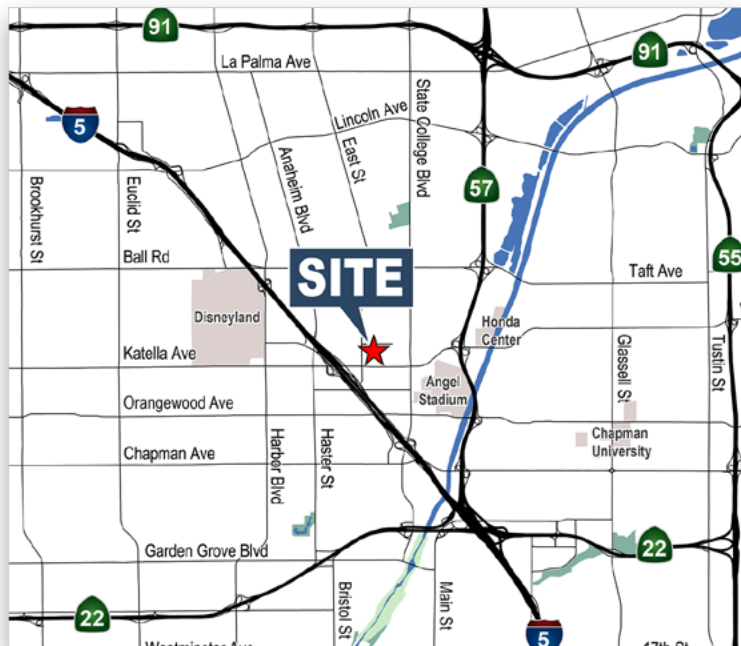

FEATURES

- ± 10,839 Sq. Ft. Industrial Building
- ± 5,000 Sq. Ft. of Office Area (*Can Be Modified or Removed to Suit*)
- High Image Building Area
- Two (2) Ground Level Doors
- Fenced Yard Area
- 600 Amps of 120/208 Volt Power
- 18' Warehouse Clearance
- Fire Sprinklered
- Prime Stadium Location

Michael Hefner, SIOR Executive Vice President

714.935.2331
mhefner@voitco.com
Lic. #00857352

Brenden Hefner Senior Associate

714.935.2326
bhefner@voitco.com
Lic. #02114046

2400 E. Katella Ave., Suite 750, Anaheim, California 92806
714.978.7880 | 714.978.9431 Fax | Lic #01991785 | www.VoitCo.com

Voit
REAL ESTATE SERVICES

HV HEFNER
VERNICK
TEAM

FOR LEASE | ±10,839 SF INDUSTRIAL BUILDING

1000 E. HOWELL AVE. | ANAHEIM | CA

SITE PLAN

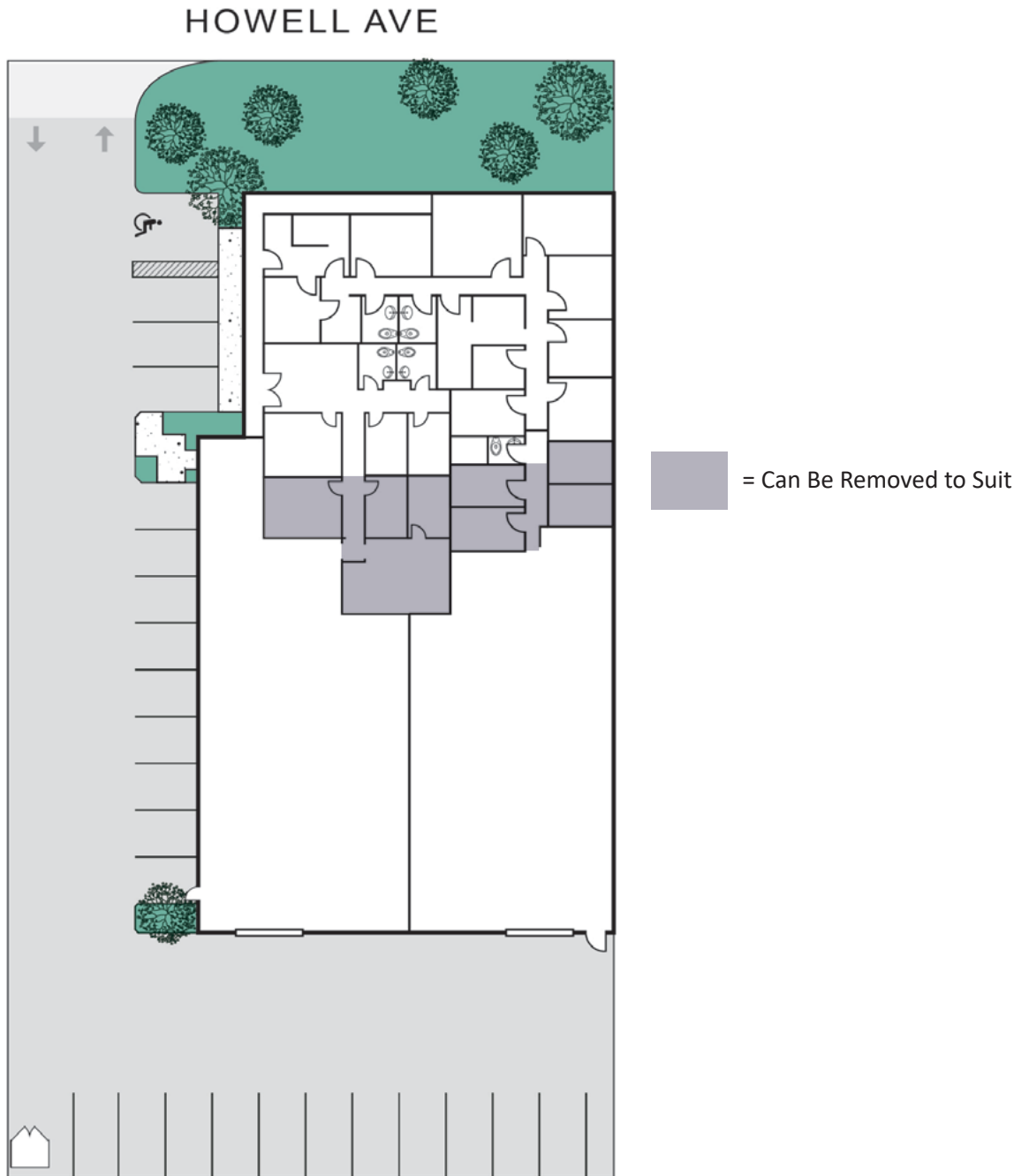

*Site plan not to scale

Michael Hefner, SIOR
Executive Vice President

714.935.2331
mhefner@voitco.com
Lic. #00857352

Brenden Hefner
Senior Associate

714.935.2326
bhefner@voitco.com
Lic. #02114046

Voit
REAL ESTATE SERVICES

HV HEFNER
VERNICK
TEAM

2400 E. Katella Ave., Suite 750, Anaheim, California 92806
714.978.7880 | 714.978.9431 Fax | Lic #01991785 | www.VoitCo.com

The information contained herein has been obtained from sources we deem reliable. While we have no reason to doubt its accuracy, we do not guarantee it. Licensed as Real Estate Salespersons by the DRE.
©2023 Voit Real Estate Services, Inc. All Rights Reserved. License #01991785.