

FOR SALE

DIVISIBLE INDUSTRIAL BUILDING

1121 - 1127 E. Ash Avenue, Fullerton, CA

12,000 SQUARE FEET (DIVISIBLE)



Property Features

- Investor or Owner Occupant Opportunity
- Two or Three Unit Industrial Building (Currently Three 4,000 SF Units)
- Building can be Delivered Vacant or Partially to Fully Leased
- Two (2) Fenced Yards with Drive Through Access
- Freestanding Building on 23,681 SF Land Parcel (No Association)
- 33% of Property has been Fully Refurbished
- Natural Gas
- Five (5) Ground Level Loading Doors
- Ample Power Distribution
- 2:1,000 Parking Ratio Plus Street Parking
- 14 Feet of Minimum Warehouse Clearance
- Excellent Access to the 91, 57 and 5 Freeways

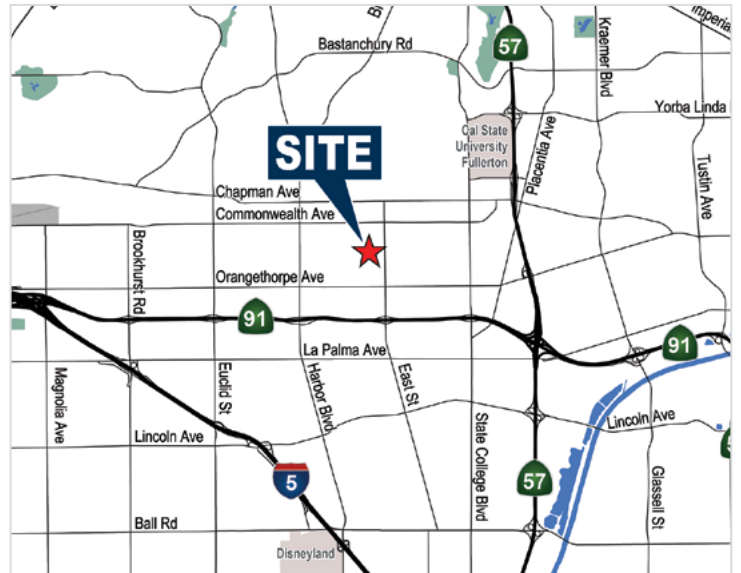

MIKE VERNICK, CCIM, SIOR

Senior Vice President, Partner

714.935.2354

mvernick@voitco.com

Lic. #01420885

Voit
REAL ESTATE SERVICES

**HEFNER
VERNICK
TEAM**

FOR SALE

DIVISIBLE INDUSTRIAL BUILDING

1121 - 1127 E. Ash Avenue, Fullerton, CA

SITE PLAN

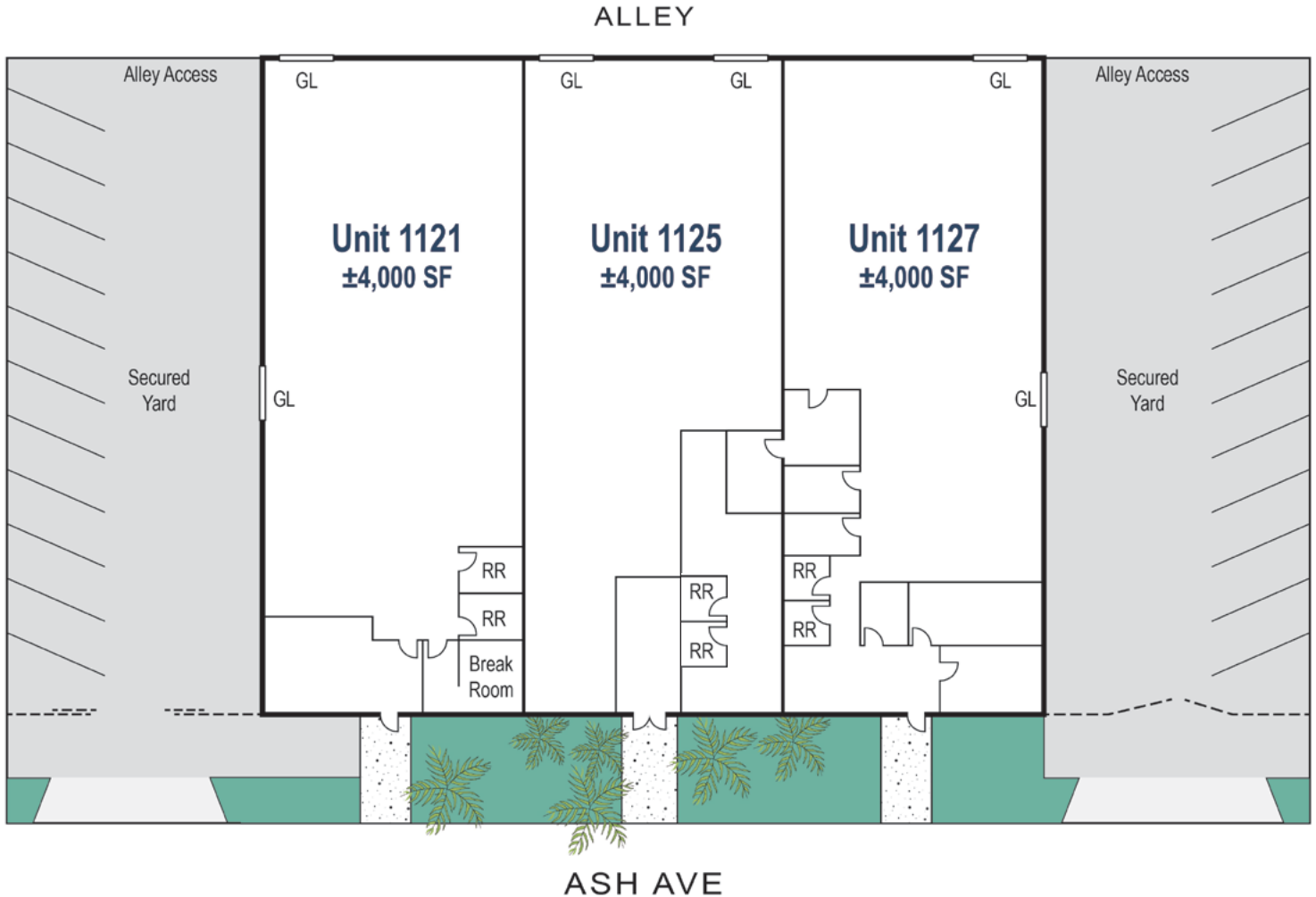

MIKE VERNICK, CCIM, SIOR

Senior Vice President, Partner

714.935.2354

mvernick@voitco.com

Lic. #01420885

Voit

REAL ESTATE SERVICES



HEFNER
VERNICK
TEAM

2400 E. Katella Ave., Suite 750, Anaheim, CA 92806 • 714.978.7880 • 714.978.9431 Fax

www.HefnerVernickTeam.com

Licensed as Real Estate Broker(s) and Salesperson by the CA Bur of Real Estate. The information contained herein has been obtained from sources we deem reliable. While we have no reason to doubt its accuracy, we do not guarantee it. ©2020 Voit Real Estate Services, Inc. All Rights Reserved. License #01991785.