

# FOR LEASE ±31,153 SF

## FREESTANDING INDUSTRIAL BUILDING

135 Via Trevizio, Corona, CA



### Property Features

- ±31,153 SF Freestanding Building
- ±4,442 SF of Office / Showroom Space (Can Be Modified to Suit)
- Two (2) Ground Level Doors
- Two (2) Dock Loading
- 28' Warehouse Clearance (Verify)
- 600 Amps of Power (Verify)
- Fire Sprinklered (0.60 / 2,000 GPM)
- Excellent Freeway Access



**MIKE HEFNER, SIOR**  
Executive Vice President  
714.935.2331  
Lic. #00857352  
mhefner@voitco.com

**Voit**  
REAL ESTATE SERVICES

**HEFNER  
VERNICK  
TEAM**

# FOR LEASE ±31,153 SF

## FREESTANDING INDUSTRIAL BUILDING

135 Via Trevizio, Corona, CA

### SITE PLAN

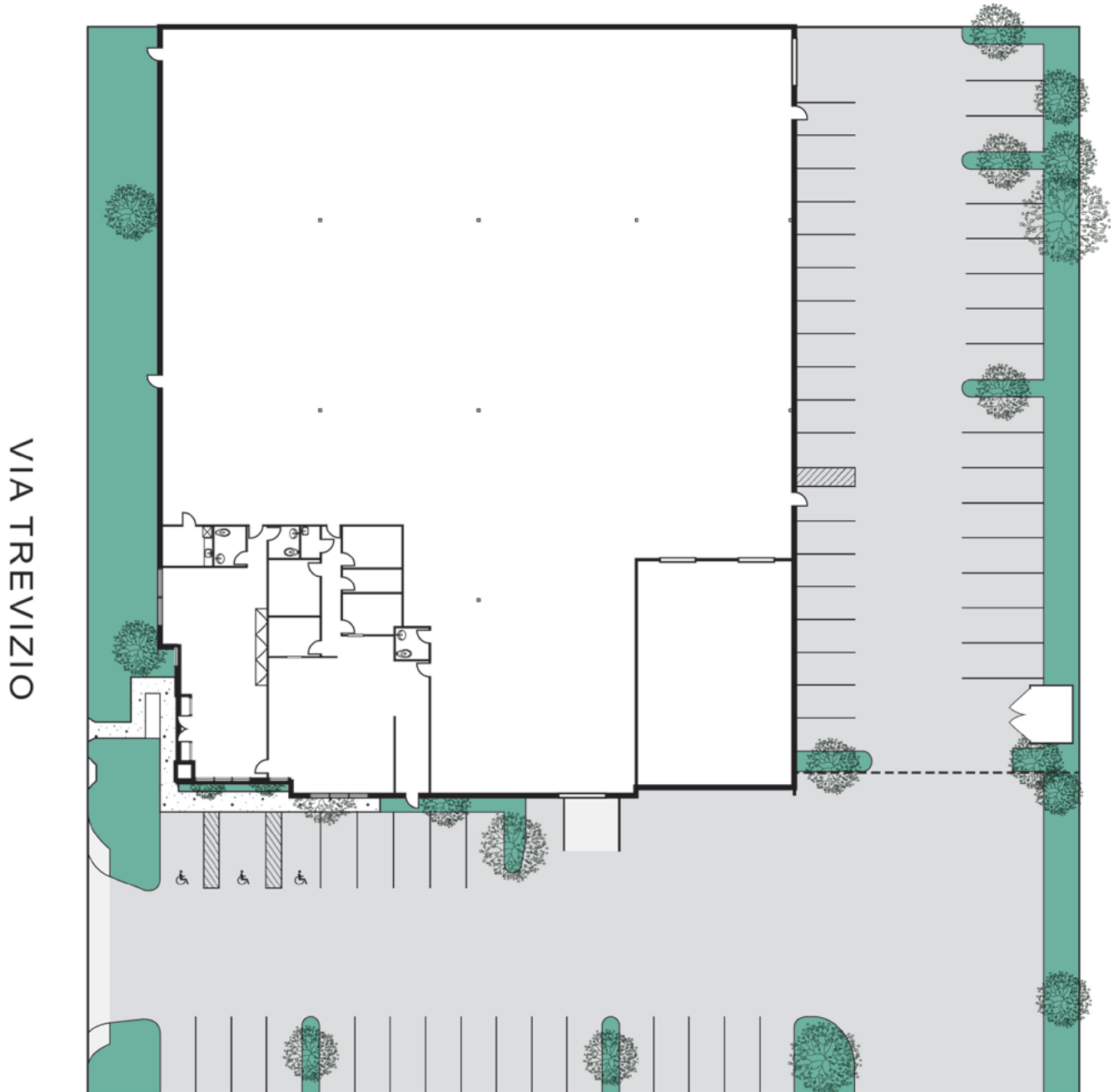

**MIKE HEFNER, SIOR**  
Executive Vice President  
714.935.2331  
Lic. #00857352  
mhefner@voitco.com

**Voit**  
REAL ESTATE SERVICES

**HV** HEFNER  
VERNICK  
TEAM

2400 E. Katella Ave., Suite 750, Anaheim, CA 92806 • 714.978.7880 • 714.978.9431 Fax

Licensed as Real Estate Broker and Salesperson by the CA Bur of Real Estate. The information contained herein has been obtained from sources we deem reliable. While we have no reason to doubt its accuracy, we do not guarantee it. ©2026 Voit Real Estate Services, Inc. All Rights Reserved. License #0133376.

[www.VoitCo.com](http://www.VoitCo.com)